

# TIKIFLEX 3001

## Flexible Polyolefin Waterproofing Tape

### DESCRIPTION

**TIKIFLEX 3001** is a high performance waterproofing joint tape designed for water tightness of outside expansion and construction joints exposed to high and permanent water pressure.

TIKIFLEX 3001 is highly elastic, root-resistant and chemically resistant tape and is suitable for installation with adhesives and sealants on various building substrates in critical areas with high and / or frequent movements.



### ADVANTAGES

- Ensures water tightness of structural connections.
- Easy to apply and user friendly.
- Fusible with standard hot air dryers.
- Long lasting elasticity and service life.
- Maintains elasticity even in low temperatures.
- Resistant to tear, wear and abrasion.
- Root resistant.
- Resistant to bacteria and the deformation of chemicals attacks.
- Resistant to ozone and U.V rays.
- Resistant to alkalis, acids and salt solutions (for special cases, test before using).

### USES

**TIKIFLEX 3001** is used for waterproof sealing of:

- Expansion and construction joints, including large ones and that subjected to considerable high and or frequent movements
- Dynamic cracks and natural joints on structures
- Corners and junctions before waterproofing treatment
- Pipes and drains
- Expansion joints in precast panels
- Expansion joints together with sealant application

For construction and maintenance works in:

- Above and below ground applications
- Tunnels and basements
- Road joints and hydraulic works
- Foundations and curtain walls
- Pools & Treatment plants
- Balconies and parapet joints
- Roofs and terraces
- Bridges and viaducts
- Dams, reservoirs and water ducts

### APPLICATION INSTRUCTIONS

#### SURFACE PREPARATION

All surfaces should be sound, clean, and dry, free from cracks, honeycombs, oil, grease, laitance and loose particles.

Newly laid cementitious systems should be at least 28 days old with moisture content <4%.

Irregularities on the substrate must be repaired.

TIKI POLYSEAL, polysulphide sealant application in the expansion joints is recommended prior to **TIKIFLEX 3001** application.

## APPLICATION

Mix **TIKIFIX EP** thoroughly, following the guidelines. Apply the well-mixed epoxy adhesive on both sides along the joint or crack on the prepared substrate, preferably with a notched trowel or spatula. Layer thickness should be about 1-2 mm. ensure that expansion joint is not covered with **TIKIFIX EP**.

Immediately after application of **TIKIFIX EP**, unroll and apply the **TIKIFLEX 3001** tape, pressing it against the adhesive, stretching the ends by hand, taking care to avoid wrinkling and air bubbles, until the underlying adhesive totally wets the sides of the **TIKIFLEX 3001** tape.

Apply second layer of **TIKIFIX EP** on the sides of **TIKIFLEX 3001** tape, in order to protect it permanently from accidental damage and to obtain monolithicity of the end to the support.

For the joint between two adjacent **TIKIFLEX 3001** tape, grind the end edges with sandpaper and fuse the end laps (using a special hot air welding machine) overlapping about 10cm. For additional security of the overlapped seal, a small layer of **TIKIFIX EP** should be applied on the welded flaps.

The final system resistances will be reached after about 7 days after laying, but already after 24 hours, 60-70% of the final performances can be obtained. In any case the performance after 24 hours will be much greater than those of a high-quality concrete.

When sealing cracks, or narrow joints the **TIKIFLEX 3001** should not be fully bonded on the joint. Centre line of the tape must be kept clean for elongation, expansion and contraction.

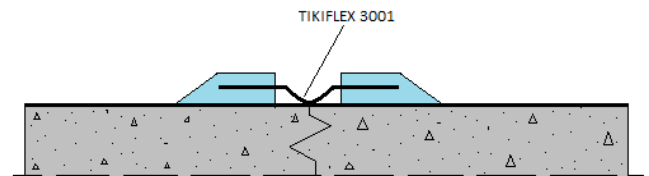

Sealing of Cold Joints

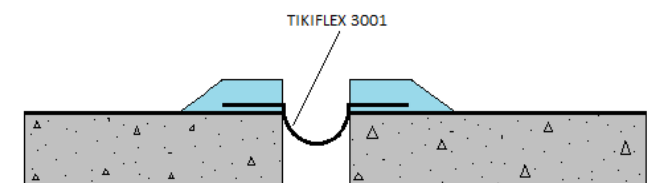

Sealing of Expansion Joints

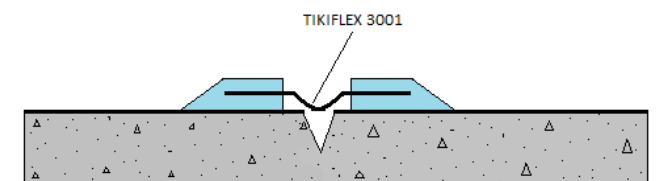

Sealing of Cracks

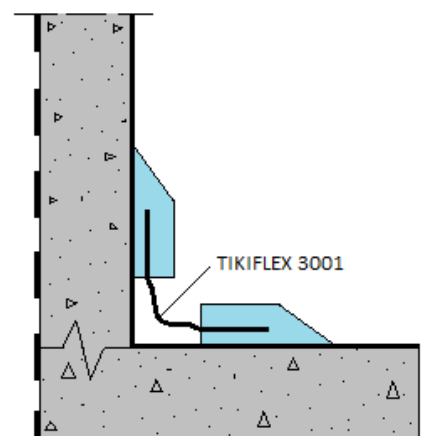

Sealing of a 90° Construction Joints

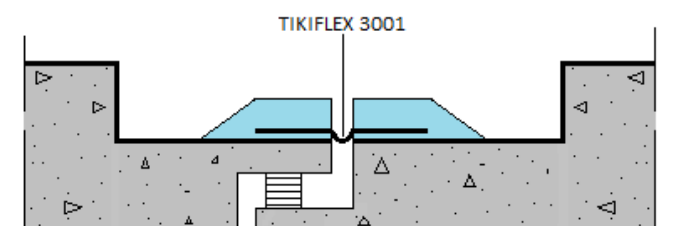

Waterproofing of Specific Joints

### IMPORTANT POINTS

- Centre line of **TIKIFLEX 3001** must be kept clean for elongation.
- It is recommended to apply sealant (TIKI POLYSEAL) in expansion joints prior to **TIKIFLEX 3001** application.
- Liquid applied waterproofing coatings must be applied over TIKIFIX EP for proper watertightness.

### FUSIBILITY

The product is fusible with standard hot-air-dryers (recommendation  $\geq 1500$  watt /  $340^{\circ}\text{C}$ ). It is important to select a low temperature setting so that only the surface of the tape melts in order not to affect the tightness of the product. Parts to be welded must be roughened or sanded.

### PROPERTIES

Property	Standard	Value
Colour	-----	Grey
Tear resistance – lengthwise	DIN EN 12311-2 Method B	$\geq 12.5 \text{ N/mm}^2$
Tear resistance – across	DIN EN 12311-2 Method B	$\geq 12.5 \text{ N/mm}^2$
Elongation at break – lengthwise	DIN EN 12311-2 Method B	$\geq 500 \%$
Elongation at break – across	DIN EN 12311-2 Method B	$\geq 500 \%$
Tear resistance (nail shank)-lengthwise	DIN EN 12310-1	$\geq 200 \text{ N}$
Tear resistance (nail shank)-across	DIN EN 12310-1	$\geq 200 \text{ N}$
Water vapour permeability	DIN EN 1931 Method B	$\geq 40 \text{ m}$
Shore A hardness	-----	Approx.. 87
Bonding strength	DIN EN 1348	$\geq 4 \text{ N / mm}^2$ *
Peel test on wood carrier	-----	$\geq 100 \text{ N}$ *

Water tightness	DIN EN 1928-A 60 kPa/24 Std.	watertight
	DIN EN 1928-B 400 kPa/72 Std.	watertight
Burst pressure	-----	> 4 bar
UV-Resistance:	DIN EN ISO 4892-3	$\geq 6500 \text{ h}$
Reaction to fire	DIN ISO 11925-2 EN 13501-1	Class E
Temperature Resistance	-30 $^{\circ}\text{C}$ to 90 $^{\circ}\text{C}$	
Chemical Resistance	Resistance to Hydrochloric acid, Potassium hydroxide, Lactic Acid, Sulphuric acid, Sodium hypchlorite, Salt water and other chemicals	

\*Depends upon the type of adhesive used

### SUPPLY

**TIKIFLEX 3001** is supplied as pre-fabricated tape and is available in following dimensions and thickness:

Description	Value	Tolerance
Thickness	1 mm	$\pm 0.1\text{mm}$
Available widths	150,200,250,500 mm (widths between 100 mm & 1000 mm upon request)	$\pm 2\text{mm}$
Weight	930 g / m $^2$	$\pm 50\text{g/m}^2$
Length per roll	20 Meter (Alternative make ups upon request)	$\pm 1\%$

### STORAGE

**TIKIFLEX 3001** must be stored above 5 $^{\circ}\text{C}$ . Store under the shed & protect from extremes of temperature, heat, direct sunlight. It has a shelf life of 12 months when stored under the covered shed in sealed condition. If packaging film has been opened, apply the material within 2 months.

### SAFETY PRECAUTIONS

As with all synthetic products, care should be taken during use and storage of **TIKIFLEX 3001**.

**VERSION: R5, 202203**

**Disclaimer:** The technical information, and, in particular, the recommendations relating to the application and end-use of Tiki Tar Danosa (TIKIDAN) products, are given in good faith based on TIKIDAN's current knowledge and experience of the products when properly stored, handled and applied under normal conditions in accordance with TIKIDAN's recommendations. The information herein is of a general nature and no assumption can be made as to a product's suitability for a particular use or application and no warranty in respect of merchantability or of fitness for a particular purpose can be inferred from this information. The user alone is fully responsible for the product's suitability for the intended application and purpose. TIKIDAN reserves the right to change the properties of its products.

**Note:** Field service where provided does not constitute supervisory responsibility. Suggestions made by TIKIDAN either orally or in writing may be followed, modified or rejected by the owner, engineer or contractor since they, and not TIKIDAN, are responsible for carrying out procedures appropriate to a specific application. TIKIDAN reserves the right to amend the composition of its material and consequently their prices, without prior notice. For this reason, all orders will be accepted only in accordance with the conditions and technical specifications in force at the date of order. Users must always refer to the most recent issue of the local Product Data Sheet for the product concerned, copies of which will be supplied on request.

## TIKITAR DANOSA (INDIA) PRIVATE LIMITED

Tiki Tar Estate, Village Road, Bhandup (W), Mumbai - 400 078,

Maharashtra, India. T: +91 22 4126 6699

E: [info@tikidan.in](mailto:info@tikidan.in) | W: [www.tikidan.in](http://www.tikidan.in)



ISO 9001:2015